



Replacement Parts List No. 700052300
Revision L 08/2021

Daikin

**SmartSource[®] Compact Vertical
Water Source Heat Pump**

WGCV
036, 042
Design 1

Contents

Parts List Revision History	3
Nomenclature	
Serial Number.....	4
Model Number	4
Electrical Legend	5
Blower Fan Assembly	
PSC Motor, Housing & Wheel: Code 10= P	6, 7
EC Motor, Housing & Wheel: Code 10= C, T	8
Refrigeration Circuit	
Diagrams	9
Components	10, 11
Hot Gas Reheat (HGRH)	11
Control Box	
Microtech III Controls	
Diagrams	12
Components	13
MTIII Control Board Label Location	14
Field Installed Accessories	15- 19
Critical Parts List	CPL1

Parts List Revision History

Revision	Date	Description
NEW	06/16	New.
A	07/17	<p>Page 6, 7: Delete fasteners p/ns 04929302, 105915405, 802012067, and 06652401.</p> <p>Page 8: Change Compressor Mounting Detail drawing.</p> <p>Page 9: Change Sleeve p/n 060623401 to WB1044. Add Washer p/n 040500322. Add Compressor Blanket p/n 669280501 & 669280601.</p> <p>Page 11: Add drawing of "No PSC Used". Add C01 Bub# 72.</p> <p>Page 12: Chart redone without voltage columns. Add Ref# 72 for Capacitors.</p> <p>Page 14: Add Thermostats & Sensor p/ns 668375301, 668375401, 667720401, and 107096010.</p> <p>Page 15: Delete EWT sensor p/n 91012131 and add WSE Coil Assy p/n 670213501. Add Hydronic Coil Assy p/n 670226304. Move Electric Duct Heater Kits to this page and delete page.</p> <p>Page 16: Add "Auto Flow Supply and Return w/Ball Valves and Strainer" p/ns for 3 Ft. hose kits.</p> <p>CPL1- Update revision.</p>
B	12/17	<p>Page 9: Change low pressure switch to 910171267.</p> <p>Page 10: Add HGRH Diagram.</p> <p>Page 14- 16: Numerous changes to Field Installed Accessories. Add sensor adapter plates, sensors, and touch screen thermostats. Add Jumper Hose p/n 669483201.</p> <p>CPL1: Update revision.</p>
C	01/18	<p>Page 12: Change contactor p/n 910140339 to 910199932.</p> <p>CPL1: Update revision.</p>
D	09/18	<p>Page 4: Change Code 21 to Always 0.</p> <p>Page 6, 7: Change Housing & Wheel Assy p/n 670227700 to 670227702 and 670227701 to 670227703.</p> <p>Page 9, 10: Change Rev Valve p/n 910118735 to 910198401 & Solenoid p/n 106694207 to 910198415. Add adapter p/n 106475001. Add differential pressure switch p/n 910170469.</p> <p>Page 11: Add page for HGRH.</p> <p>Page 12: Change Contactor p/n 910140339 to 910199932.</p> <p>Page 15- 19: Numerous format changes. Change Filters from Kit #s to individual p/ns. Delete Tstat p/ns 668375301 & 668375401. Add page.</p> <p>CPL1: Update revision. Change Housing & Wheel Assy p/n to 670227703 and 670227702.</p>
E	10/18	<p>Page 13: Add footnote for disconnect switch and delete unit size. Change contactor p/n 910140340 to 910199932. Change unit size for capacitor Ref# 68 & 72.</p> <p>CPL1: Update revision.</p>
F	03/19	<p>Page 6: Add motor arm p/n 910163977 & band p/n 910121966 for 208/230V mtrs after 3/19. Add 208/230V mtr for belly band p/n 910234780 (036).</p> <p>CPL1- Update revision. Add 1/3HP motors for 208/265V.</p>
G	05/19	<p>Page 6: Delete PSC motor dwg without belly band & add motor mount detail. Change 036 motor p/n 669484212 to 910236666; 669484213 to 910234779 and motor 042 p/n 669484214 to 910234785; 669484215 to 910234783. Add arm p/n 910159261 & band p/n 910175300.</p> <p>Page 9: Change fitting p/n 910170469 to 910154735.</p> <p>Page 10: Move HGRH from page 11.</p> <p>Page 15- 19: Add compressor blanket kit p/n 910221738. Change H-8 Harness p/n 910107989 to 910255908 and 10 pack p/n 910145646.</p> <p>CPL1- Update revision. Change motors.</p>
H	09/19	<p>Page 4: Code 9 delete F. Code 11 delete D.</p> <p>Page 6 - 9: Add page for PSC diagrams. Add support flange rear & side Bub # 330 & 335. Add footnote 1 for motors needing belly bands. ECM motors delete housing, ring & wheel.</p> <p>CPL1- Update revision.</p>
J	07/20	<p>Page 11: Updated p/n for Ref. 520 Reheat Valve, was 910163981, and Ref. 530 Solenoid, was 910110439.</p>
K	04/21	<p>Page 4: Added option SD to Code 12.</p> <p>Page 6: Updated p/n's for Ref. 320 Blwr Hsg & Wheel Assy- 4/18 & later, were 670227702, 670227703.</p> <p>CPL1: Updated p/n's for Blwr Hsg Assy, were 670227702 (size 036), 670227703 (size 042). Update revision.</p>
L	08/21	<p>Various: Corrected misc. formatting, spelling, & footnote issues.</p> <p>Page 6, 7: Rewrote pg. header & updated the TOC.</p> <p>Page 8: Rewrote pg. header & updated the TOC. Changed "ECM Motor" to "EC Motor".</p> <p>Page 11: Rewrote footnotes.</p> <p>Page 18: Rewrote pg. header.</p> <p>CPL1: Add TXV p/ns. Update revision.</p>

Nomenclature

Serial Number

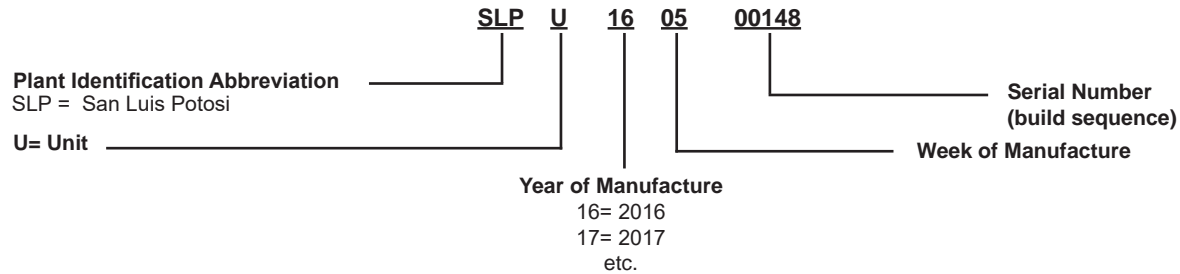

Model Number

	W	G	C	V	0	3	6	E	1	R	T	G	M	P	B	0	0	1	0	0	0	S	5	0	0	0	
Code	01 - 03	04	05	06	07	08	09	10	11	12	13	14	15	16	17	18	19	20	21								

Code 01: Unit Type

W= Water Source Heat Pump

Code 02: Model Type

GC= Compact- 1 Stage

Code 03: Configuration

V= Vertical

Code 04: Unit Size

036= 36000 BtuH Nominal Cooling
042= 42000 BtuH Nominal Cooling

Code 05: Voltage

E= 208-230/60/1 F= 208-230/60/3
J= 265/60/1 K= 460/60/3

Code 06: Design Series

1= Design Series 1

Code 07: Return/Discharge Air

LT= Left Hand Return/Top Discharge
RT= Right Hand Return/Top Discharge

Code 08: Water Coil Type

C= Copper Inner Tube
S= Cupro-Nickel Inner Tube
G= Geothermal- Copper Inner Tube
J= Geothermal- Cupro-Nickel Inner Tube

Code 09: Unit Control

M= Microtech III Base Controller
L= Microtech III Base Controller with Lon
B= Microtech III Base Controller with BACnet

Code 10: Fan Motor

P= PSC
C= ECM Constant CFM
T= ECM Constant Torque

Code 11: Insulation (Compressor Side / Airside)

B= Basic Standard- Fiberglass/Fiberglass
I= IAQ- Closed Cell Foam/Closed Cell Foam
F= Sound Blanket- Basic Standard- Fiberglass/Fiberglass
G= Sound Blanket- IAQ- Closed Cell Foam/Closed Cell Foam
H= Sound Blanket- Fiberglass/Dual Layer Fiberglass

Code 12: Options

WE= Waterside Economizer
HG= HGRH
HH= Hydronic Heat
SD= Simplified Dehumidification
00= None

Code 13: Filters & Racks

1= Standard 1" Rail 1" Filter, Throwaway
2= 2" Rack- 2" Filter, MERV 8
3= 2" Rack- 2" Filter, Throwaway
4= 4" Rack- 4" Filter, MERV 13
5= 4" Rack- 2" Filter, Throwaway

Code 14: Piping Package

0= None

Code 15: Electric Heat Size

0= None
P= Control for Electric Heat Single 24V Signal

Code 16: Freeze Fault Protection

0= None
F= Freeze Fault Protection

Code 17: Standard or Special

S= Standard
X= Special

Code 18: Transformer

50= 50 VA Transformer
75= 75 VA Transformer

Code 19: Corrosion Protection

0= None
C= Corrosion Protection

Code 20: Disconnect Switch

0= None
D= Disconnect Switch

Code 21: Always 0

Code 22: Extended Warranty

Electric Legend

AN1, AN2	LED Annunciator
CO1	Capacitor, Fan Motor
C11	Capacitor, Compressor
CP1	Compressor
COE	Condensate Overflow Protection Sensor - WSE
COS	Condensate Overflow Protection Sensor
DAT	Discharge Air Temperature Sensor
DCS	Disconnect Switch
EB1	Expansion Control Board 1
EB2	Expansion Control Board 2- Fan Speed Control
EWT	Entering Water Temperature Sensor
FM1	Fan Motor
HG1	Hot Gas Reheat Valve Actuator
HP1	High Pressure Switch
HYH	Hot Water Heat Valve Actuator
LAT	Leaving Air Temperature Sensor
LP1	Low Pressure Switch
LT1	Compressor Suction Line Temperature Sensor
LWT	Leaving Water Temperature Sensor
M01	Contactora, Fan Motor
M11	Contactora, Compressor
MCB	Main Control Board
NCB	Network Control Board
OLP	Overload Protector - Compressor Motor
RAT	Return Air Temperature Sensor
RV1	Reversing Valve
TR1	Transformer - Control
TR2	Transformer - Fan Motor
WSE	Waterside Economizer Actuator

Blower Fan Assembly

PSC Motor, Housing & Wheel: Code 10= P

Diagrams

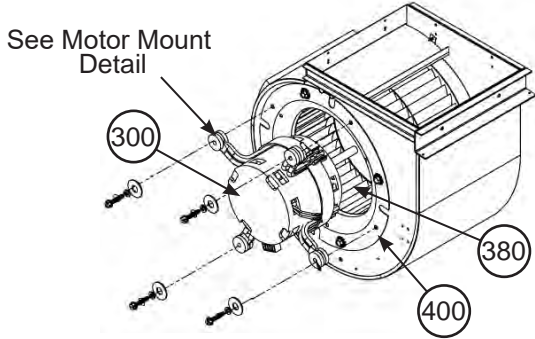

Blower Fan Assembly
Size 036 shown

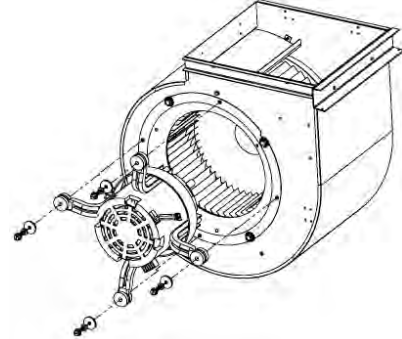

Blower Fan Assembly
Size 042 shown

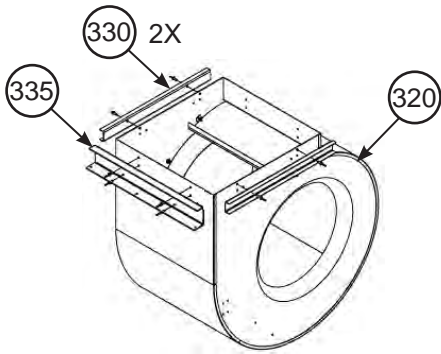

Blower Housing Assy

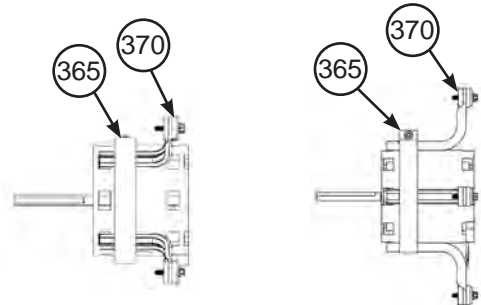

Size 036

Size 042

Motor Mount Detail

Blower Fan Assembly

PSC Motor, Housing & Wheel: Code 10= P

Components

Ref. No.	Part Description	Part Number	036				042		
			208-230/60/1	208-230/60/3	265/60/1	460/60/3	208-230/60/1	208-230/60/3	460/60/3
300	PSC Motor, 1/3 HP	910164123	1	1					
	PSC Motor, 1/3 HP ¹	910234780	1	1					
	PSC Motor, 1/3 HP	669484212			1				
	PSC Motor, 1/3 HP ¹	910236666			1				
	PSC Motor, 1/3 HP	669484213				1			
	PSC Motor, 1/3 HP ¹	910234779				1			
	PSC Motor, 1/2 HP	669484214					1	1	
	PSC Motor, 1/2 HP ¹	910234785					1	1	
	PSC Motor, 1/2 HP	669484215							1
	PSC Motor, 1/2 HP ¹	910234783							1
320	Blower Housing Assy	670227700	1	1	1	1			
	Blower Housing Assy	Q670212113	1	1	1	1			
	Blower Housing Assy	670227701					1	1	1
	Blower Housing Assy	670212114					1	1	1
330	Support Flange, Side	910167368	2	2	2	2			
		910165247					2	2	2
335	Support Flange, Rear	910235401	1	1	1	1			
		910235402					1	1	1
365	Band- Motor Mount	910121966	1	1	1	1			
		910175300					1	1	1
370	Arm- Motor Mount	910163977	4	4	4	4			
		910159261					4	4	4
380	Wheel, Blower	802000037	1	1	1	1			
		910160766					1	1	1
400	Inlet Ring	060828801	1	1	1	1			
		060829001					1	1	1

¹ This motor uses a band & arm motor mount.

Blower Fan Assembly

EC Motor, Housing & Wheel: Code 10= C, T

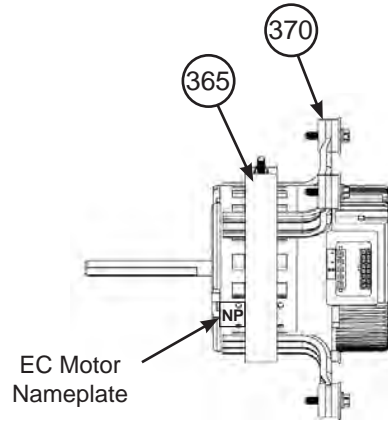
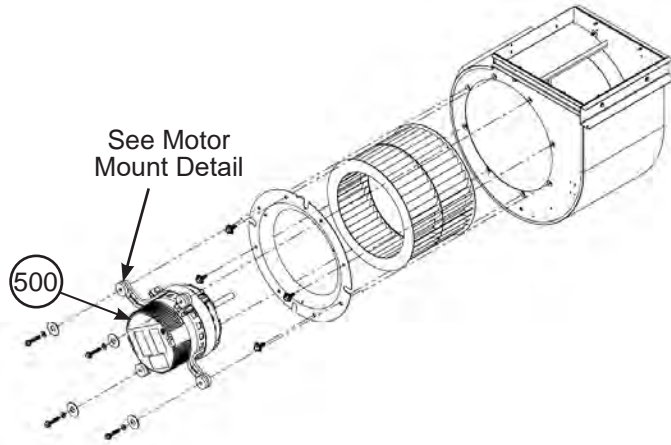

Motor Mount Detail

Ref. No.	Part Description	Part Number	Unit Size	
			036	042
365	Band- Motor Mount	910121966	1	
		910175300		1
370	Arm- Motor Mount	910163977	4	
		910159261		4
500	EC Motor & Program	1	See EC Motor nameplate.	

¹ The p/n for the EC Motor is found on the label (see illustration above).
 You may also contact Daikin with the Unit Model & Serial Number to get the EC Motor part number.

Refrigeration Circuit Diagrams

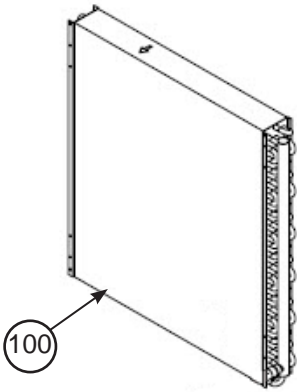

Evaporator Detail

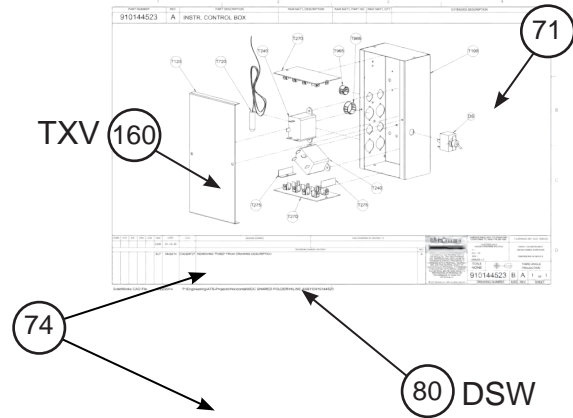

CO-AX HEAT EXCHANGER Detail

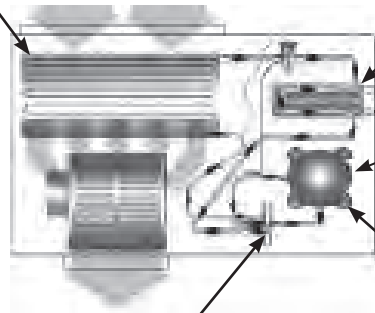

Compressor

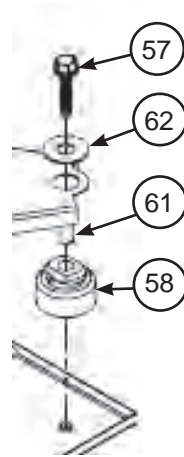

Compressor Mounting Detail

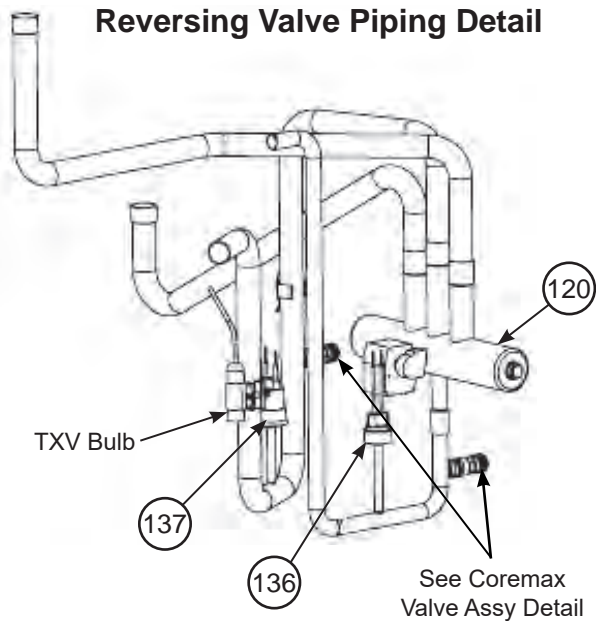

Reversing Valve Piping Detail

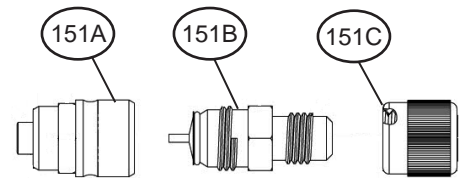

Coremax Valve Assembly Detail

Refrigeration Circuit Components

Ref. No.	Description	Part Number	036				042		
			208-230/60/1	208-230/60/3	265/60/1	460/60/3	208-230/60/1	208-230/60/3	460/60/3
57	Screw, Compressor Mount	910155795	4	4	4	4	4	4	4
58	Grommet, Compressor Mount	4RHZ9154	4	4	4	4	4	4	4
61	Sleeve, Compressor Mount until 7/16	060623401	4	4	4	4	4	4	4
	Sleeve, Compressor Mount 7/16 & later	WB1044	4	4	4	4	4	4	4
62	Washer, Compressor Mount	040500322	4	4	4	4	4	4	4
69	Compressor	910131941	1						
	Compressor	910131942		1					
	Compressor	910131940			1				
	Compressor	910131943				1			
	Compressor	668392201					1		
	Compressor	668392202						1	
N/S	Compressor	668392203							1
	Compressor Blanket	669280501	1	1	1	1			
71	Compressor Blanket	669280601					1	1	1
	CO-AX Heat Exchanger, Copper Inner Tube	669814139	1	1	1	1			
	CO-AX Heat Exchanger, Copper Inner Tube	669814140					1	1	1
	CO-AX Heat Exchanger, Cupro Inner Tube	910170637	1	1	1	1			
74	CO-AX Heat Exchanger, Cupro Inner Tube	910170638					1	1	1
74	Adapter	106475001	2	2	2	2	2	2	2
80	Differential Pressure Switch	910170469	1	1	1	1	1	1	1
100	Evaporator Coil Assy, Return Air- LH ¹	670211317	1	1	1	1	1	1	1
	Evaporator Coil Assy, Return Air- RH ¹	670211312	1	1	1	1	1	1	1
120	Reversing Valve until 4/18	910118735	1	1	1	1	1	1	1
	Reversing Valve 4/18 & later	910198401	1	1	1	1	1	1	1
N/S	Solenoid- Reversing Valve until 10/17	106694207	1	1	1	1	1	1	1
	Solenoid- Reversing Valve 10/17 & later	910198415	1	1	1	1	1	1	1
136	High Pressure Switch	910171269	1	1	1	1	1	1	1
137	Low Pressure Switch until 9/16	107225101	1	1	1	1	1	1	1
	Low Pressure Switch 9/16 & later	910171267	1	1	1	1	1	1	1
151A	Seat, Fitting	910158114	2	2	2	2	2	2	2
151B	Core, Valve	668188701	2	2	2	2	2	2	2
151C	Cap, Valve	668189501	2	2	2	2	2	2	2

N/S= Not shown on diagram.

¹ Please contact Daikin for E-Coat on evaporator coil assy.

Refrigeration Circuit Components, Continued

Ref. No.	Description	Part Number	036				042		
			208-230/60/1	208-230/60/3	265/60/1	460/60/3	208-230/60/1	208-230/60/3	460/60/3
160	Expansion Valve	910156635	1	1	1	1			
	Expansion Valve	910157451					1	1	1
N/S	Drain Pan, LH	670212811	1	1	1	1	1	1	1
	Drain Pan, RH	670212802	1	1	1	1	1	1	1
	Terminal Ring- Condensate Overflow Wire	802007936	1	1	1	1	1	1	1
N/S	Gasket, Vinyl Edging, 10.69"	910155307	1	1	1	1	1	1	1

N/S= Not shown on diagram.

Hot Gas Reheat (HGRH)

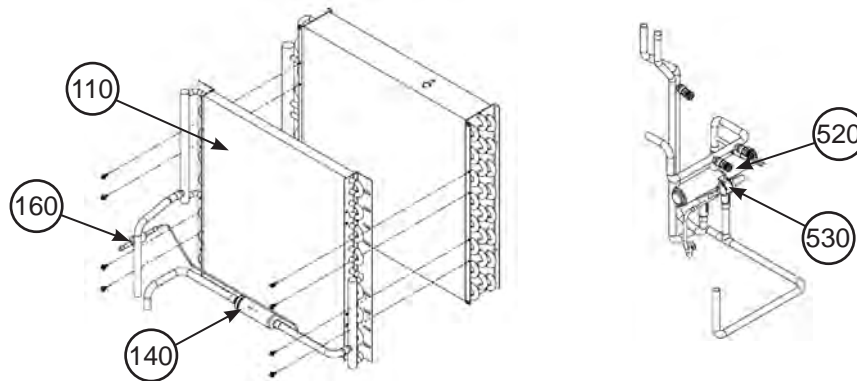

Ref. No.	Part Description	Part Number	Unit Size	
			036	042
110	Hot Gas Coil Assy, LH ¹	670209911	1	1
	Hot Gas Coil Assy, RH ¹	670209904	1	1
140	Check Valve, .5 ODS	910115254	1	1
160	Check Valve, Equalizer, .25 ODF	910171818	1	1
520	Re-Heat Valve, 2 Ton	910226303	1	1
530	Solenoid	910198415	1	1

¹ Please contact Daikin for E-Coat on HGRH coil assy.

Control Box

MicroTech III Controls

Diagrams

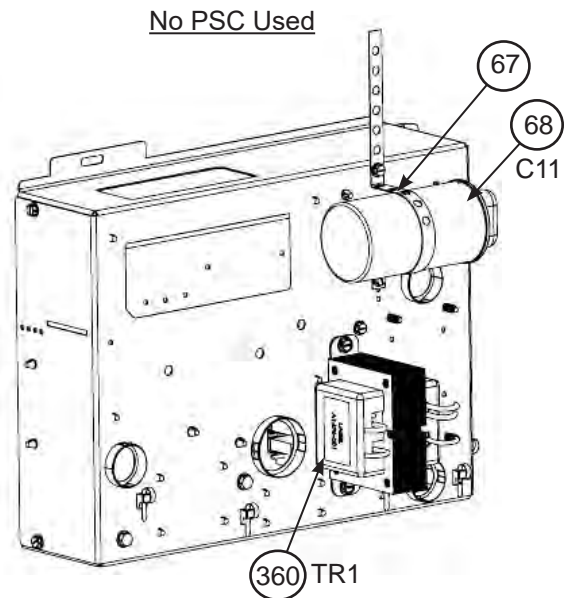
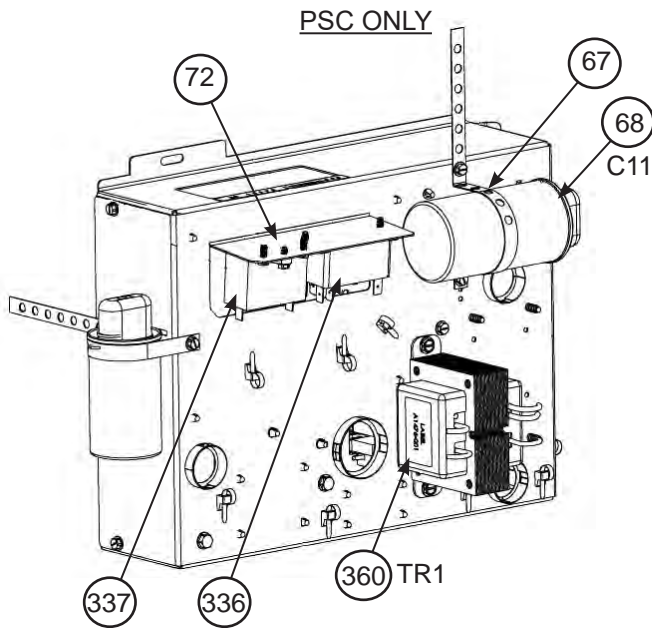
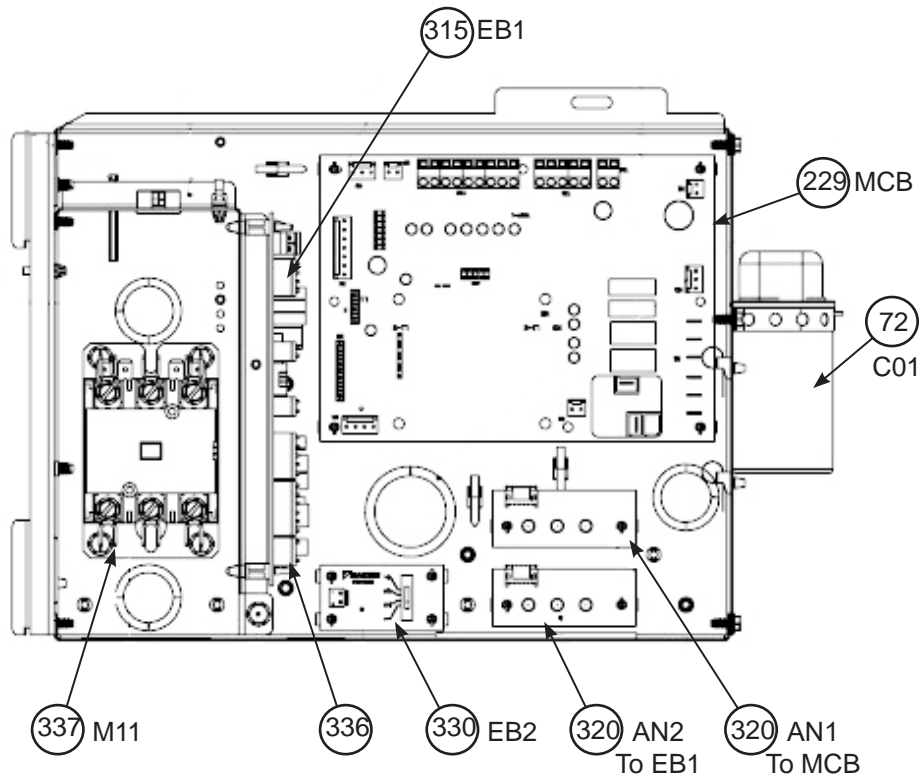

Control Box MicroTech III Controls Components

Ref. No.	Part Description	Part Number	Unit Size		
			036	042	
67	Bracket, Capacitor	850010570	1	1	
N/S	Boot, Capacitor Terminal Cover	910127697	1	1	
68	Capacitor, Compressor, 45MFD 440VAC	910120052	1	1	
	Capacitor, Compressor, 60MFD 440VAC	910120055	1		
72	Capacitor, Blower Motor, 7.5MFD, 440V	910120044	1		
	Capacitor, Blower Motor, 15MFD, 440V	910120046		1	
229	Control Board, MicroTech III	668105601 ²	1	1	
315	I/O Expansion Board	668105702*	1	1	
320	LED Annunciator	668395201	1	1	
330	Fan Speed Selection Board	910143618	1	1	
335	Stand Off, PC Board	802028115	6	6	
336	Relay, 24V	106500102	1	1	
337	Contactor, 2P, 30A	until 12/17	910140339	1	1
	Contactor, 2P, 32A	12/17 & later	910199934	1	1
	Contactor, 3P, 32A	until 12/17	910140340	1	1
	Contactor, 3P, 32A	12/17 & later	910199932	1	1
N/S	Disconnect Switch, 10A		910150557	See footnote 1.	
	Disconnect Switch, 16A		910150558		
	Disconnect Switch, 25A		910150560		
	Disconnect Switch, 45A		910118577		
360	Transformer, 50V, 208-230V		910116202	1	1
	Transformer, 50V, 265V		910116203	1	
	Transformer, 50V, 460V		910116205	1	1
	Transformer, 75V, 208-230V		910116213	1	1
	Transformer, 75V, 265V		910116209	1	
	Transformer, 75V, 460V		910116209	1	1
N/S	Suction Line Temp Sensor (LT)		910121228	1	1
N/S	Air Temp Sensor (DAT, RAT)		910106325	1	1
N/S	Water Temp Sensor (EWT, LWT)		910121231	1	1





N/S= Not shown on diagram.

¹ The disconnect switch depends on the unit features. Use the As-Built BOM on Parts E-Commerce, or get the specs from the installed disconnect, or contact Daikin Applied Parts Identification.

² When ordering this board, please provide the software part number printed on the board's label. See control board photo on next page for label location.

Control Box

MicroTech III Controls

MTIII Control Board Label Locations	
 <p style="text-align: right; margin-right: 50px;">Label</p>	 <p style="text-align: right; margin-right: 50px;">Label</p>
668105702	668105901
 <p style="text-align: right; margin-right: 50px;">Label</p>	 <p style="text-align: right; margin-right: 50px;">Label</p>
668105601	668105801

NOTE: When ordering the control board, please provide the software part number printed on the board's label.
See above for label locations.

Field Installed Accessories

Filters & Filter Racks

Description	Qty	Part Number
1" Throwaway Filter	12 Pack	910156850
2" MERV 8 Filter	12 Pack	669814407
4" MERV 13 Filter	6 Pack	669814408
Filter Rack, 2"	1 Kit	910174052
Filter Rack, 4"	1 Kit	910174059

MicroTech III Communication Modules

Description	Part Number
BacNet Comm Module Kit ¹	910128889
LonWorks Comm Module Kit ¹	910128888

¹ Kit includes comm module card, sensors, mounting tabs, and IM.

Motorized Valve Wire Harness

Description	Part Number
MTIII, H-8 Wire Harness Assy, ISO Control Kit	910255908
MTIII, H-8 Wire Harness Assy, ISO Control Kit, 10 Pack	910145646

Manual Valves

Description	Size	Box of 2	Box of 10
Combination Shutoff/Balancing Valve with Memory Stop	3/4" FPT	106065202	106065210

Motorized Valves

Description	Kit ²	Actuator	Body
2-Way Valve Kit, Motorized, Normally Closed (NC), 3/4" NPT	910131354	910129596	910129297
2-Way Valve Kit, Motorized, Normally Closed (NC), 3/4" Sweat	910131360	910129596	910129294
2-Way Valve Kit, Motorized, Normally Open (NO), 3/4" NPT	910128987	910129299	910129297
2-Way Valve Kit, Motorized, Normally Open (NO), 3/4" Sweat	910131357	910129299	910129294

² Refer to IM 1151 for installing a motorized valve kit on MicroTech III units.

Field Installed Accessories Continued

Thermostats & Sensors

Description	Part Number
3.75" x 5.5" Adaptor Plate ¹	910201987
5.25" x 7" Adaptor Plate ¹	910193064
5.3" x 5.3" Adaptor Plate ¹	910201988
RCN Kit for use with wireless Tstat	910107248
Programmable/ Non- Programmable, 2H/2C, AC, Touchscreen	910193126
Programmable/ Non- Programmable, 2H/2C, AC, Touchscreen, WIFI	910193131
Wall Stat: Non- Programmable, 2 Heat/2 Cool, ACO, Hardwired	910121746
Wall Stat: 7-day Programmable, 2 Heat/2 Cool, ACO, Hardwired	910121748
Wall Stat: Auto, Programmable Touch-Screen, 3 Heat/2 Cool, Humidity Detection	910121750
Wall Stat: Programmable & Remote Sensor	910116773
Wall Stat: AC/DC, ACO, 7-day Programmable, 2 Heat/2 Cool with Wall Plate	668375301
Wall Stat: AC/DC, ACO, Non- Programmable, 2 Heat/2 Cool, NSB & OR with Wall Plate	668375401
Trim Ring ¹	910193063
Insulated Wall Plate	910116770
Basic Room Sensor with NSB, Override and Status LED	910152149
Digital Adj. 4-Button Room Sensor with Override, Occupancy Switch and Temp. Display	910152147
Sensor with Cool/Warm Temp Adj. and Occupancy Override	910171464
Remote Sensor, Outdoor Temp for Touch Screen Thermostat ²	910129096
Remote Sensor, Indoor Temp for Touch Screen Thermostat ²	910129095
Wall Temp Sensor for 668375301 & 668375401	107096010
Wall Sensor, Adj. Cool/Warm, Occupancy Switch	910121753
Room Sensor, Digitally Adj., Temp & Humidity Display	910121754
Wall Temp Sensor, Daikin Branded ³	667720401

¹ For sensors p/ns 910121754, 910152147, 910152149 or 910171464.

² For use with thermostats # 910121750.

³ For use with thermostats # 910121746 & # 910121748.

TStat Guards

Description	Part Number
TStat Guard	105571101
TStat Guard (10 Pack)	105571110

Field Installed Accessories Continued

Waterside Economizer

Description	Part Number
3-Way Valve Body, 3/4" Sweat	910167523
WSE Coil Assy	670213501
Actuator, 24V	107179809

Hydronic Heat

Description	Part Number
Hydronic Coil Assy	670226304
Actuator, 24V	107179801

Electric Duct Heater Kit

Description	5 KW	10KW	15KW	20KW
208/230/60/1V	910128971	910128976	910128980	910128983
208/230/60/3V	910128973	910128977	910128981	910128984
265/60/1V	910128974	910128978	N/A	N/A
460/60/3V	910128975	910128979	910128982	910128985

Compressor Blanket

Description	Unit Size	Part Number
Compressor Blanket Kit	036	910221738
Compressor Blanket Kit	042	910221739

Field Installed Accessories Continued

Hoses

Description	Specification	2 Foot	3 Foot
Hose Kit, Fire Rated Condensate	3/4"	106063801	106063901
Hose Kit, Plastic Condensate	3/4"	106063701	106665101
Hose Kit, Fire Rated Supply/Return (2 Pack)	3/4"	106062901	106063201
Auto Flow Supply and Return w/Ball Valves Flow Control Hose Kit, Fire Rated Supply/Return- 3/4" Includes: Supply Line: Ball valve with one port and a 24" stainless steel hose with swivel. Return Line: Combination flow controller & ball valve with two ports and a 24" stainless steel hose with swivel.	4.5 GPM	669482404	N/A
	5.0 GPM	669482405	N/A
	5.5 GPM	669482406	N/A
	6.0 GPM	669482407	N/A
	6.5 GPM	669482408	N/A
	7.0 GPM	669482409	N/A
	7.5 GPM	669482410	N/A
	8.0 GPM	669482411	N/A
	9.0 GPM	669482412	N/A
	10.0 GPM	669482413	N/A
	11.0 GPM	669482414	N/A
	12.0 GPM	669482415	N/A
	13.0 GPM	669482416	N/A
Auto Flow Supply and Return w/Ball Valves and Strainer Flow Control Hose Kit, Fire Rated Supply/Return- 3/4" Includes: Supply Line: Combination ball valve & y-strainer, blow down valve, with one port and a 24" stainless steel hose with swivel. Return Line: Combination flow controller & ball valve with two ports and a 24" stainless steel hose with swivel.	4.5 GPM	106582916	910186317
	5.0 GPM	106582917	910182844
	5.5 GPM	106582918	910186318
	6.0 GPM	106582919	910157029
	6.5 GPM	106582920	910186319
	7.0 GPM	106582921	910157030
	7.5 GPM	106582922	910186433
	8.0 GPM	106582923	910182845
	9.0 GPM	106582924	910160448
	10.0 GPM	106582925	910186434
	11.0 GPM	106582926	910186436
	12.0 GPM	106582927	910186439
	13.0 GPM	106582928	910160450
Hose Kit, Supply and Return w/Ball Valves	3/4"	669483501	669481402
Hose Kit, Supply and Return w/Ball Valves and Strainer	3/4"	669481901	669481902
Hose Kit, Jumper Hose Kit w/90° Adapter	3/4" x 4 Ft.	669483201	

N/A = Not Applicable.

Note: Refer to IM 1226 for Daikin Fire Rated Hoses & Hose Kits and for installation instructions.

Field Installed Accessories Continued

MicroTech III Temperature Sensors ¹

Part Number	Kit	Tenant Override	Setpoint Adjustment	Status LED	Fan & Mode Switch
669088101	669529001	Yes	No	No	No
668900801	669529101	Yes	55° to 95°F (12° to 35°C)	Yes	Yes
669088201	669529201	Yes	-3° to +3°F (-1.5° to 1.5°C)	No	Yes

¹ Note: Can only be used in conjunction with a communication (Comm.) card. See OM 931 for required jumper settings.

MicroTech III Unit Control Accessories

Description	Part Number
Multiple Unit Control Panel: Allows a master unit controlled by a T'Stat, to operate up to 3 secondary units Not Recommended for use with a Boilerless System Kit. ³	056794201
Boilerless System Kit with I/O Expansion Board ²	910110355
Boilerless System Kit without I/O Expansion Board	910110353

² IM 1084-2 is included in Kit.

³ Kit components listed below.

Multiple Unit Control Panel Kit

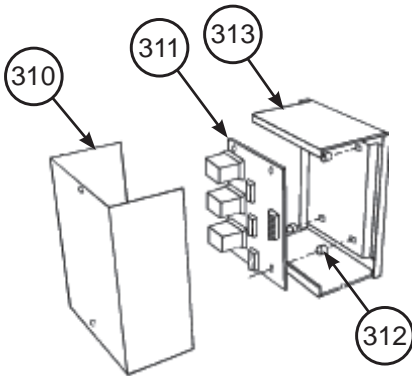

Ref. No.	Description	Part Number	Qty.
310	Cover, Control Box	106436101	1
311	Circuit Board	056794001	1
312	Stand Off, Circuit Board	802028090	6
313	Box	850007827	1

Critical Daikin Applied OEM Parts Are What Your HVAC Unit Needs!

Daikin SmartSource® Compact Vertical WSHP

WGCV

036, 042 Design 1

Critical Components	Unit Sizes	Voltage	Part Number
Control			
Control Board, MicroTech III	ALL	ALL	668105601
Compressor			
Compressor	036	208-230/60/1	910131941
Compressor	036	208-230/60/3	910131942
Compressor	036	265/60/1	910131940
Compressor	036	460/60/1	910131943
Compressor	042	208-230/60/1	668392201
Compressor	042	208-230/60/3	668392202
Compressor	042	460/60/1	668392203
Blower Fan Motor			
Motor, 1/3 HP	036	208-230/60/1/3	910234780
Motor, 1/3 HP	036	265/60/1	910236666
Motor, 1/3 HP	036	460/60/1	910234779
Motor, 1/2 HP	042	208-230/60/1/3	910234785
Motor, 1/2 HP	042	460/60/1	910234783
EC Motor & Program	ALL	ALL	See motor nameplate
Blower Fan Assembly			
Blower Housing Assy	036	N/A	Q670212113
Blower Housing Assy	042	N/A	670212114
Wheel, Blower	036	N/A	802000037
Wheel, Blower	042	N/A	910160766
Expansion Valve			
Expansion Valve (TXV)	036	ALL	910156635
Expansion Valve (TXV)	042	ALL	910157451
Sensor			
Suction Line Temp Sensor (SLTS)	ALL	N/A	910121228
Air Temp Sensor (DAT, RAT)	ALL	N/A	910106325
Water Temp Sensor (EWT, LWT)	ALL	N/A	910121231

Call Your Local Daikin Applied Parts Distributor For All Your Parts Needs.
To Locate A Distributor, Go To www.DaikinApplied.com or Call 1-800-37PARTS